

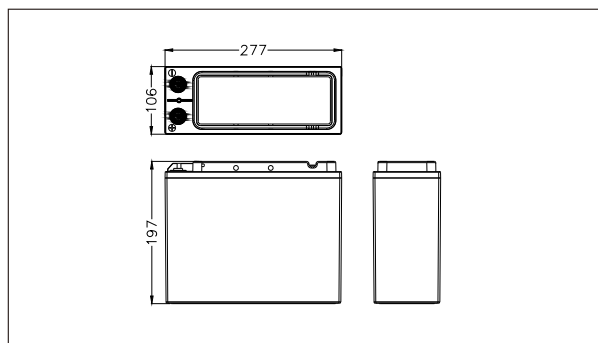

# SWF12400(12V40Ah)



### Outer dimensions (mm)



### Specifications

Nominal Voltage		12V
Rated capacity (10 hour rate)		40 Ah
Dimensions	Total Height	197 mm (7.79 inches)
	Height	197 mm (7.79 inches)
	Length	277 mm (10.9 inches)
	Width	106 mm (4.17 inches)
Weight Approx		13 Kg (28.7lbs)

### Terminal Type (mm)

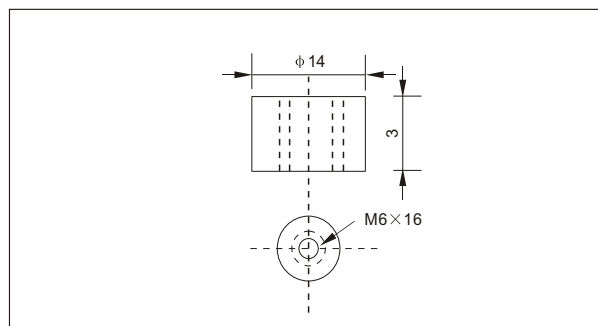

### Characteristics (25°C)

Capacity	10 hour rate(4.0 A)	40 Ah
	5 hour rate(6.4A)	32 Ah
	1 hour rate(24 A)	24 Ah
	1.5 hour discharge to 10.5V	16 A
Internal resistance	Full charged	10.0 mΩ
Capacity affected by temperature (20 hour rate)	40 °C	102%
	25 °C	100%
	0 °C	85%
	-15 °C	65%
Self-discharge	Capacity after 3 month storage	91%
	Capacity after 6 month storage	82%
	Capacity after 12 month storage	64%
Terminal	T102	
Charge (constant voltage)	Cycle	Initial charging current less than 10A Voltage 14.10V-14.40V
	Float	Voltage 13.50V-13.80V
Designed float life	10 year	

### Features

- Low self-discharge;
- Safe and reliable, low floating current;
- Excellent cycling performance;
- Separator: glass fiber with high adsorption and high stability.
- Temperature environment(-15~50°C);

### Applications

- Telecom & UPS; Medical equipment;
- Emergency lighting; Vacuum cleaner;
- Fire & security system;
- Photovoltaic & Solar & Wind power system.

### Standards

- GB/T 19639-2014; JIS C8704-1:2006; EUROBAT;
- IEC 60896-21/22:2004; UL MH26669;

Constant Current(Amp) and Constant Power(Watt) Discharge Table at 25°C (72°F)

Time		10min	30min	1h	2h	3h	4h	5h	8h	10h	20h
9.60V	A	80.0	44.0	24.0	14.0	10.4	8.4	7.1	4.6	4.4	2.3
	W	848	469	257	151	118	94	81.2	51.4	48.8	25.5
10.20V	A	76.0	43.6	22.6	13.4	10.2	8.2	7.0	4.6	4.1	2.2
	W	836	482	250	150	115	93	79	52	47	25
10.50V	A	68.0	40.8	22.0	13.0	10.0	8.0	6.4	4.5	4.1	2.2
	W	762	459	249	149	115	92	74	51	47	25
10.80V	A	64.0	37.6	21.2	12.7	9.8	7.8	6.1	4.4	4.0	2.2
	W	726	429	243	147	114	91	71	51	47	25
11.10V	A	60.0	33.6	20.0	12.4	9.4	7.6	5.8	4.3	3.9	2.2
	W	690	388	232	145	110	90	68	50	46	25



● Charge characteristics(25°C)

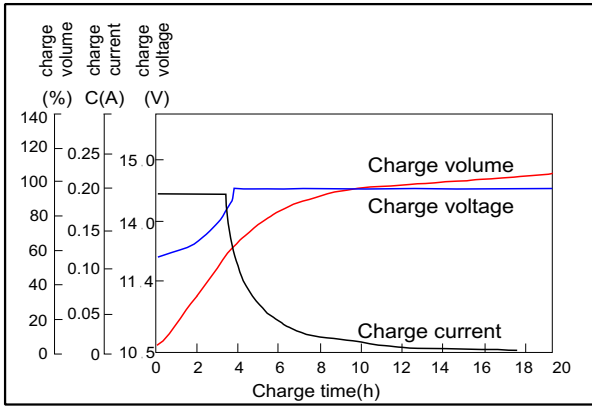

● Cycle life characteristics (25°C)

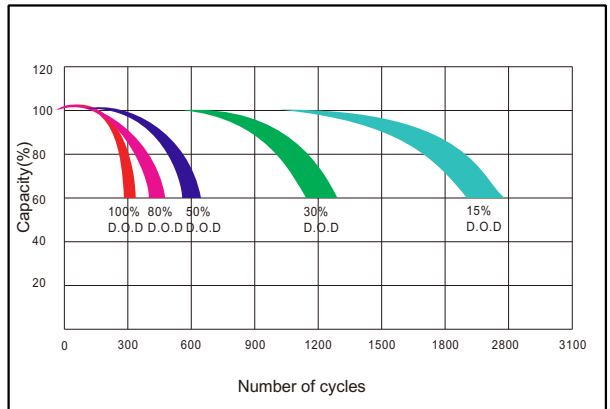

● Discharge characteristics(25°C)

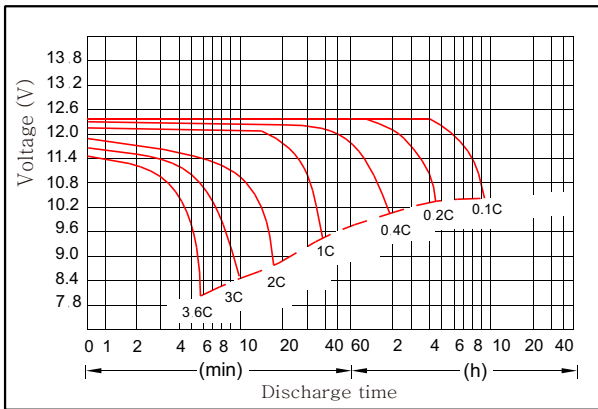

● Standby life characteristics (25°C)

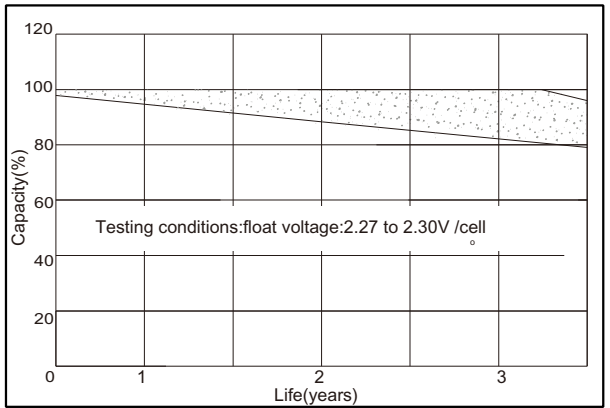

● Float life on temperature

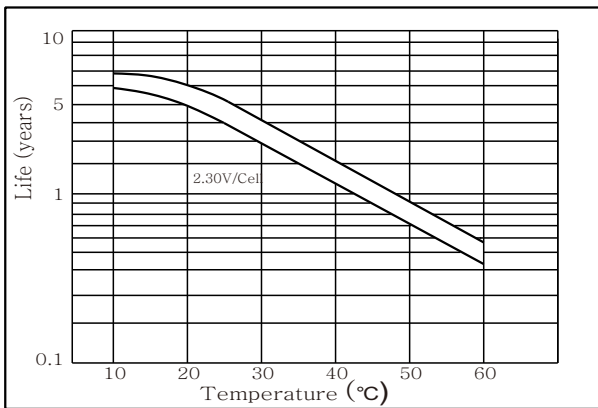

● Self-discharge characteristics

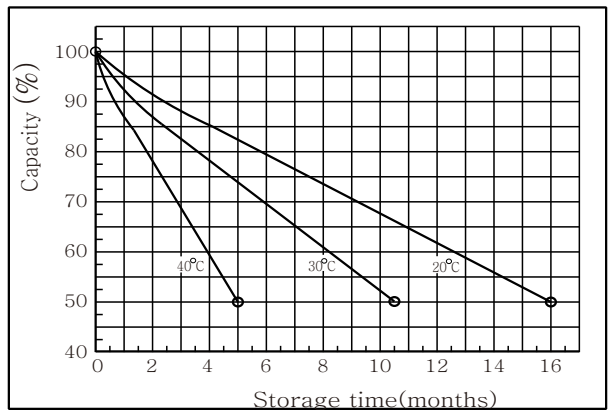

● Relationship between charge voltage and temperature

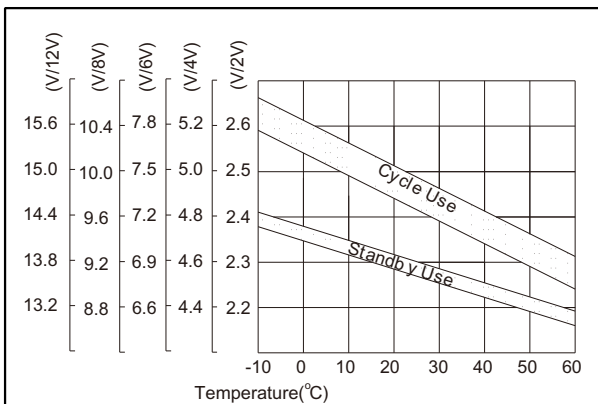

● Effect of temperature on capacity

